



ANIMAL CARE
SYSTEMS

Assembly Instructions

Single-use OptiMICE® Full Cage Assembly

1. Your shipment will arrive with parts in two boxes. One box will include: Cage Base (A), Exhaust Nozzle (F) and Bedding/Spacer Box (G). The other will include: Feeder Front and Back (C&D), Card Holder (E) and Cage Top (B). When your shipment arrives, inspect each box to ensure no damage has occurred during shipping. If the shipping box is damaged, check the inner double bags inside the container. Confirm that these bags have not been punctured, which compromises the sterility of the contents inside.



Note: Contents have been sterilized; please follow your facility's protocol to ensure sterility is maintained.

NOTE: ACS has gone through great lengths to assure all surfaces are smooth, to eliminate areas that mice can chew. Any creases, crinkles or flat edges on the Cage Base and Top represents unacceptable damage. If there is any edge that is not perfectly smooth, do not use it; replace it with a new piece.



2. Once the two packages have been opened and inspected, locate all cage assembly parts.

Cage Contents

- A – Cage Base
- B – Cage Top
- C – Feeder Front
- D – Feeder Back
- E – Card Holder
- F – Exhaust Nozzle
- G – Bedding/Spacer Box (discard if empty)



7086 South Revere Parkway, Suite #100, Centennial, Colorado 80112

Toll Free 888-827-3861 Phone 720-283-0177 Fax 720-283-0179

www.AnimalCareSystems.com

Page 1

Assembly Instructions

Single-use OptiMICE® Full Cage Assembly

3. Hold the Cage Base (A) and snap the Exhaust Nozzle (F) over the rear filter.

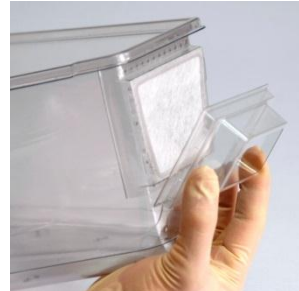

4. Assemble the feeder by snapping the Feeder Front (C) to the Feeder Back (D). Once the feeder has been assembled, fold the top tab towards the Feeder Back.



5. Once the feeder has been assembled, install it on the Cage Base. Ensure that the hanger is placed on the left-hand side (facing the rear of the cage) in the recessed section of the top edge.

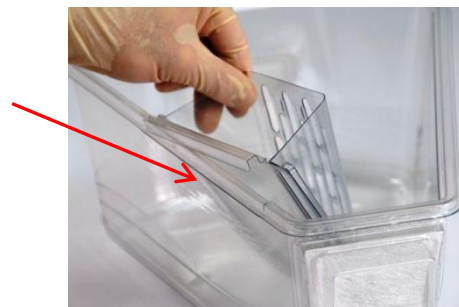



Assembly Instructions

Single-use OptiMICE® Full Cage Assembly

6. Locate the Card Holder (E). Fold in half so the tabs in the corner snap together. Once the tabs have been snapped together, fold the top tab on the perforated line away from the center crease. Once it is assembled, it can be hung on the front of the cage in the recess, similar to the feeder.

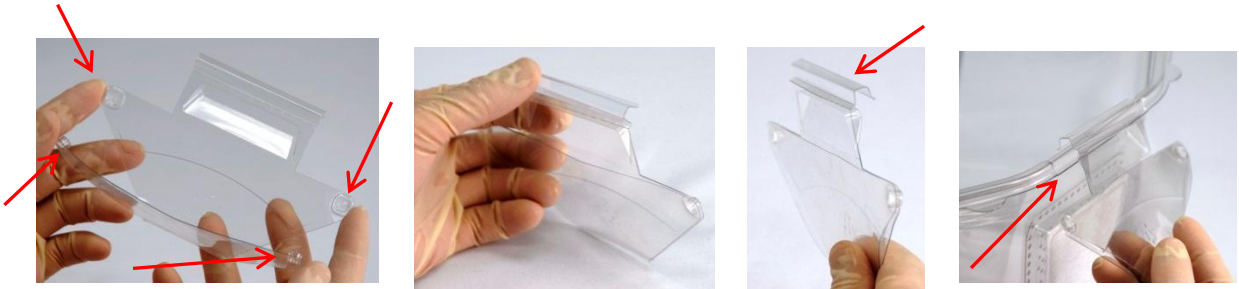

7. Open the Bedding Box (G) (if included with the purchase) and empty the contents into the Cage Base. Put the empty Bedding Box into a recycle bin.

Note: Bedding has been sterilized; please follow your facility's protocol to ensure sterility is maintained.



8. Once the bedding has been poured into the Cage Base (A), the Cage Top (B) can be installed. Be sure the Feeder and Card Holder are properly seated in their recesses.





ANIMAL CARE
SYSTEMS

Assembly Instructions

Single-use OptiMICE® Full Cage Assembly

9. Once the top is installed and secured, the Water Bottle, Hydropac® or Sipper Sack® can be installed. Ensure that the bottle or water bag fits snug in the hole provided and the nipple or valve is accessible to the animals.



10. Completed Cage:



NOTE: Cages should be assembled on-demand. ACS does not recommend assembling units that do not require immediate use. If cages are stacked please stack **ONLY** cage bases exactly how they come out of the box (8 cages high, no nozzles and a spacer box in between each Cage Base). Improper stacking can lead to damaged cages and could compromise the sterility of the product.



Assembly Instructions

Single-use OptiMICE® Cage Base Assembly Only

1. Base Assembly will include: Cage Base (A), Exhaust Nozzle (F) and Bedding/Spacer Box (G).
2. When the time comes to change out the Cage Base (A), be sure to inspect the full cage assembly and confirm that there is no damage to Cage Top (B), Feeder (C&D), and Card Holder (E). If there is any damage to these parts, be sure to follow your facility's protocol to ensure they are recycled properly.
3. Once the cage has been inspected, locate the Feeder (C&D) and install it on the new Cage Base (A) in the recess section of the top edge.
4. Install the Card Holder (E) in the front center recess.
5. Open the Bedding Box (G) (if included with the purchase) and empty the contents into the Cage Base. Put the empty Bedding Box into a recycle bin.

Note: Bedding has been sterilized; please follow your facility's protocol to ensure sterility is maintained.

6. Once the bedding has been poured into the Cage Base (A), the old Cage Top (B) can be installed. Be sure the Feeder and Card Holder are properly seated in their recesses.
7. Once the top is installed and secured, the Water Bottle, Hydropac® or Sipper Sack® can be installed. Ensure the bottle or water bag fits snug in the hole provided and the nipple or valve is accessible to the animals.



Operator's Instructions

Single-use OptiMICE® Adjusting CFM / Rack Airflow Data

The filters on the single-use cages have less surface area, meaning there is more resistance to airflow, which requires higher airflow requirements. We recommend a minimum of 60 CFM through each rack to ensure adequate cage ventilation. This corresponds to 5.5 m/s on M79210 Anemometer. A Rack Status Monitor, C79351 is also available to monitor rack airflow. If single-use cages are in an animal room with reusable OptiMICE cage racks, all racks will then be flowing 60 CFM to ensure the single-use rack is well ventilated. The optimum airflow for the single-use OptiMICE racks is higher than the reusable. We have proven through smoke testing at other facilities that 60 CFM is a more than acceptable airflow amount. Airflow above the minimum is up to the discretion of the lab director, we offer M79190 Damper Assemblies, for situations where the airflow is higher than desired.



Anemometer - M79210



Rack Status Monitor – C79351



Damper Assembly – M79190

OptiMICE / ErgoMICE Single-use Rack Airflow Data				
Rack Size	MINIMUM Air Volume Needed From Rack Exhaust	Hoses Per Rack	MINIMUM Anemometer Measurement Per Hose	RECOMMENDED Anemometer Per Hose
100-Cage OptiMICE	60	2	5.5 m/s	8.3 m/s
80-Cage ErgoMICE	51	2	4.7 m/s	7.1 m/s
70-Cage ErgoMICE	45	2	4.1 m/s	6.2 m/s
50-Cage ErgoMICE	33	1	5.9 m/s	8.9 m/s

Note: The 50-Cage ErgoMICE rack uses only one hose for ventilation. The other hose connection is capped with P/N M21080 Ceiling Flange Cap at the factory.